

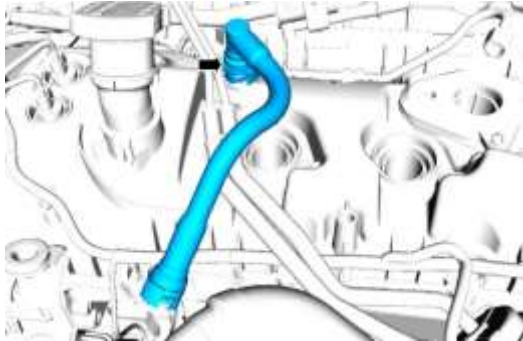

Installing Full-Race F150 EcoBoost Intake kit

The addition of a high performance catch can is an important upgrade for any vehicle. This article documents the installation of our [Full-Race F150 Catch Can](#). This straight forwards process requires basic mechanical skills and hand tools. The entire job can be performed with the truck on the ground - No need to use a lift. Once you are familiar with the process, the installation can be completed in 30 minutes.

1. Starting with a stock EcoBoost F150: first open the hood, then disconnect the battery and remove the engine cover.
2. Unclip and disconnect the OEM driver side valvecover plastic vent-tube. Set this aside, you will use it in a moment.



3. Next, Unclip and disconnect the passenger side valve cover vent tube (1) . Then, remove and unscrew the PCV valve (2) from passenger side valve cover.

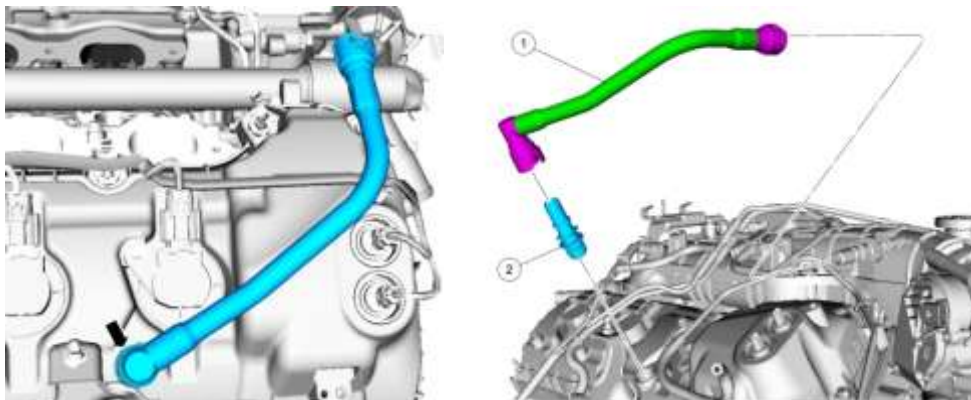

4. Next we need to pull the plastic intake manifold fitting – remove screw and pull out plastic fitting (shown in red).

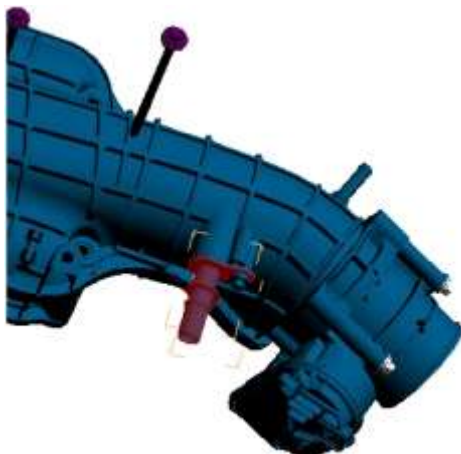

5. Replace with the Full-Race delete plug.



-OR- Note: if you use an external BOV and aftermarket Intercooler, this plug will be used as your BOV vacuum port.



OR

6. Using a small pick tool or screw driver, remove the spring and check valve from the PCV. Now is a good time to use a drill bit and remove this "step" to enlarge the opening. (Drilling is not mandatory). Reinstall gutted-PCV valve in RHS valve cover.



7. Now, get ready to mount the Catch Can on the truck - using the cowl screws. Install the drain valve on the lower corner of the catch can - and be careful not to drop or lose the screws!

2011-2014 F150:



2015+:



8. Remove the plastic Quick-Disconnect fittings (shown in purple) from the vent hoses (green). We recommend to use a heat gun, but a sharp razor blade can work also. Save the fittings, discard the hose.

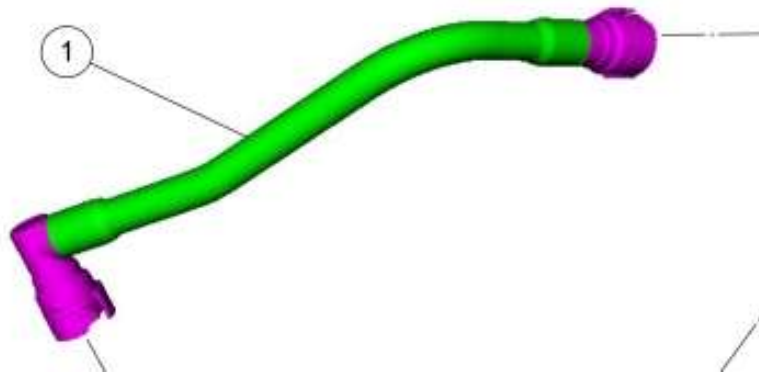

9. Install the straight fittings on the valve covers and cut the hose to fit.

Note: 2015+ Vehicles must retain the crankcase flow sensor.

2011-2014:



2015+:



10. Inspect the Installation, tighten hose clamps. Drain the catch can when you change your oil – or sooner. The photo below shows approx 1500 miles in a humid environment.

